



# HERRINGBONE LAMINATE INSTALL GUIDE

## 1. GENERAL INFORMATION

- Due to the nature of the flooring material, it is difficult to rebuild or repair it after installing, so the condition of the floor and the construction site must be checked carefully before installing;
- The issues can be happened after installing, and it should be fully discussed with the agency and house owner.

## 2. PRECAUTIONS

- Variations in the subfloor flatness should not exceed 1/16" per 3ft (2mm/m). Floors must be leveled to meet this specification prior to installation. Level by filling depressed areas with floor leveling compounds and sanding or grinding down raised any areas;
- Floor moisture: Construction shall be carried out when the water content of the floor is less than 5%;
- Construction direction: The construction direction must be worked in consultation with the customer.

## 3. PRIOR TO INSTALLATION

- ① **Subfloor preparation:** Clean the floor so that there are no foreign substances (cement residue, sand) on the floor of the construction site.
- ② **Concrete:** A 0.12" (3mm) thick underlay and 8 mil (0.2mm) polyethylene vapor barrier must be used when installing over concrete.
- ③ **PE - FOAM installation:** Underlay edges should not be overlapped. But end edges together and seal with adhesive tape.
- ④ **Doors/Door Jamb:**
  - Laminate floors should be installed under door jambs so your door jambs will need to be undercut accordingly.
  - Make sure to leave the correct expansion spacing.
- ⑤ **Precautions:**
  - Laminate floors expand and contract with changes in relative humidity. For this reason, it is necessary to leave a 3/8" (10mm)
  - The expansion space around the perimeter of the room and all other objects (e.g. toe kicks, plumbing, etc.).
  - The expansion space will be covered by the wall base or quarter round once the floor is installed.

## 4. INSTALLATION INSTRUCTIONS



1 Ensure your subfloor is level and tidy from any debris.

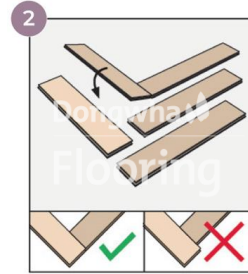

2 To start, take two B boards and three A planks. Click your first B board into the **header joint**<sup>1</sup> of your first A board and form the classic 'V' shape.

<sup>1</sup> When installing your flooring, it is important to note that each board is designed with a four-sided click system to allow the boards to slot easily into one another. To create the classic herringbone pattern, you will need to use board A and board B (the board type should be written on the base). This can be achieved by slotting the shorter side of the board into the longer side of the board at a medium angle. The shorter end of the board is known as the 'header joint'.

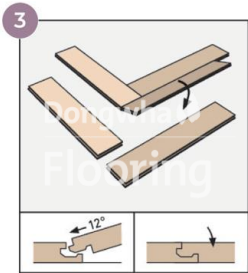

3 Next, get your second A board and place it to the right of the V shape, clicking it into place.



4 Now, take the second B board and place it into the left of your V shape, clicking it into place. Then take the third A board and place it to the right of your V shape and click it into place.

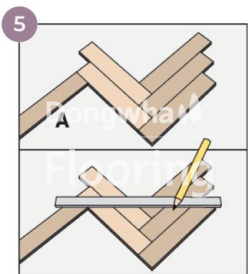

5 Next, take a fourth A board and click the header joint into place into the second B board.

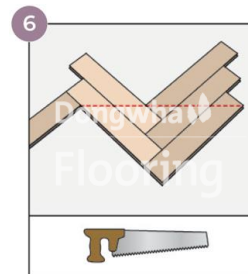

6 From the top right corner of the third A board, to the top right corner of the fourth A board, mark a straight line and cut along it with a saw.

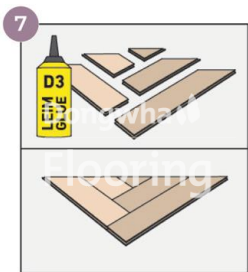

7 This will leave you with an inverted triangle. Disconnect the boards, glue and stick back together to make your shape sturdy and secure.

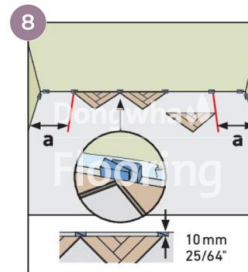

8 From the center of the rear wall, work your way outwards placing your inverted triangles, leaving a 10mm at the back and side walls.

## 4. INSTALLATION INSTRUCTIONS

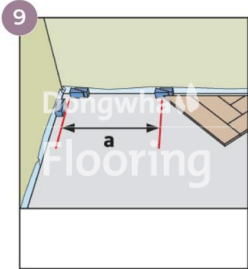

When it comes to fitting the last inverted triangle to the left and right-hand wall. For section a, ensure that you measure the distance and leave a 10mm gap between your flooring and the wall.

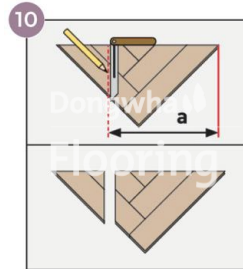

For the left-hand wall, use the distance measured for section a, and mark (right-to-left) on the inverted triangle and cut this section. For the right-hand wall, mark (left-to-right) and cut this section.

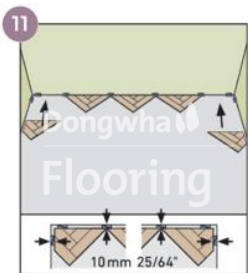

Your two cut inverted triangles will now slot into place alongside your other inverted triangles.

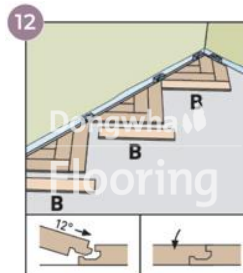

Now comes the following rows. For the first row of boards, work from right-to-left, placing B boards to the left of each inverted triangle, clicking them into place.

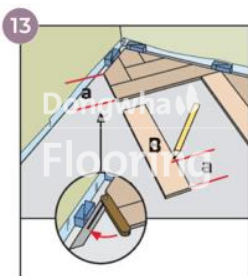

When it comes to laying your last board, similarly to the previous, take the measurement for section a and mark it on your B board.

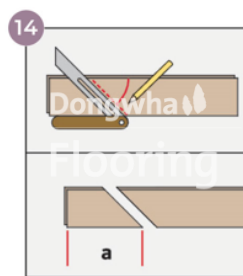

Then, cut the measurement for section a at a 45-degree angle to ensure it fits nicely into the remaining space.

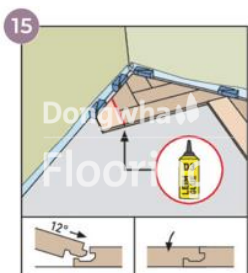

Now, glue the board to the inverted triangle to ensure it is sturdy and stable.

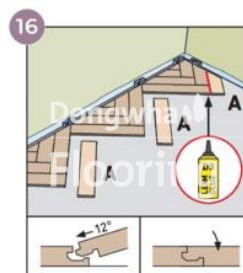

When it comes to the next row of boards, place your A boards to the right of each inverted triangle clicking them into place.

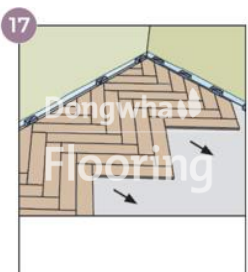

Make sure you continue this method of laying your boards, using B boards from right-to-left and A boards from left-to-right.

## 5. ENDING PROFILE

- Ⓐ Be careful not to use too much adhesive as it could fill the expansion zone;
- Ⓑ Ensure that you leave at least 3/8"(10mm) expansion space between moldings and laminate floors;
- Ⓒ Never fasten moldings directly to the laminate flooring.

## 6. CARE & MAINTENANCE

- Laminate floors are among the highest performing floors available, but they are not indestructible and minor cosmetic scuffing is normal wear for any laminate floors. To ensure your floors perform as well in the future as the day after you install them;
- Place walk off mats and area rugs at main traffic entrances and protective pads under furniture legs to prevent scratching;
- Vacuum or dust mop to remove loose dirt or grit;
- Never flood the floor with water or cleaner; wipe up spills immediately;
- Do not use polishes, waxes or abrasive cleaners.